

# Unrivalled quality, priceless reliability

The ECOSYS MA6000ifx offers the best of Kyocera quality and high-speed printing. Built to last, this ECOSYS model also offers robust security features and fax capabilities, ideal for the most demanding small to medium-sized workspaces.

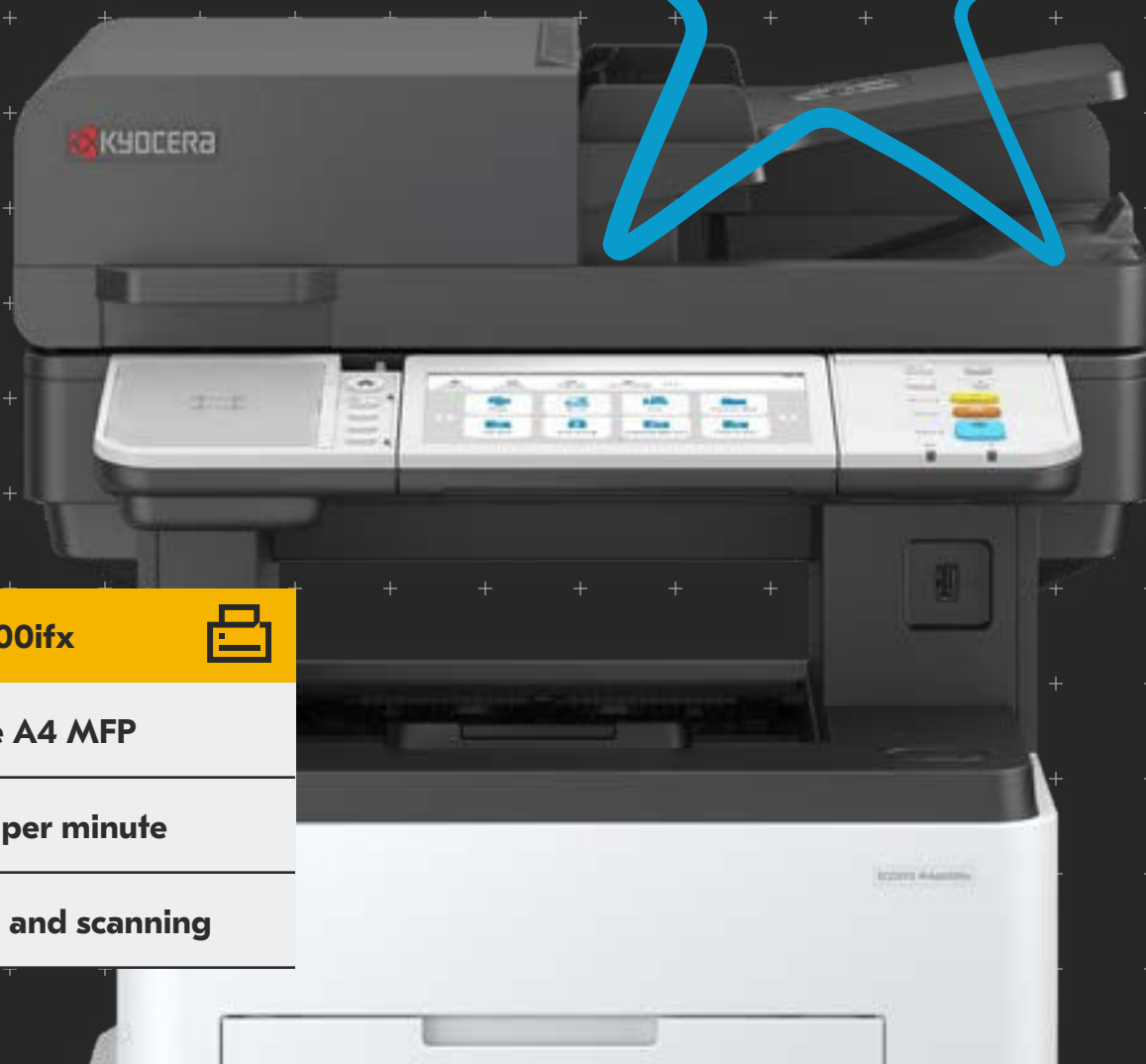

**ECOSYS MA6000ifx**



**Black and white A4 MFP**

**Up to 62 pages per minute**

**Duplex printing and scanning**

**BASIC SPECIFICATIONS**

**Configuration:** Multifunctional Printer - Print/Copy/Scan/Fax  
**Pages per Minute:** Letter: 62 ppm; Legal: 50 ppm;  
 Statement: 92ppm, StatementR: 32 ppm  
**Duplex Print Speed:** Letter: 44 ppm; Legal: 25 ppm  
**Display:** 7" Color Touch Screen Control Panel (TSI)  
**Warm Up Time:** 25 Seconds or Less (Power On)  
**First Page Out Time:** Copy: 6 Seconds or Less (with Document Processor), 7 Seconds or Less (without Document Processor),  
 Print: 4.5 Seconds or Less  
**Resolution:** 600 x 600 dpi, Fine1200 (1200 x 1200 dpi) and  
 Fast1200 (1800 x 600 dpi) Interpolated Resolution  
**Memory:** Std/Max: 1.5 GB / 3.5 GB  
**Duplex:** Standard Stackless Duplex Supports Statement to  
 Legal (5.5" x 8.5" - 8.5" x 14"), 16 lb. Bond - 67 lb.  
 Index (60 - 120gsm)  
**Dimensions / Weight:** 18.8" W x 19.4" D x 24.1" H / 54 lbs.  
**Maximum Monthly Duty Cycle:** 300,000 Pages per Month

**POWER CONSUMPTION**

**Electrical Requirements:** 120V, 60Hz, 10A;  
 220-240V, 50Hz, 5.6A  
**Typical Electricity Consumption (TEC):**  
 120V: 0.84 kWh/week; 220-240V: 0.84 kWh/week  
**Maximum (including Options):** 120V: 1,231 W;  
 220-240V: 1,309 W  
**Copy / Printing:** 120V: 729.1/744.4 W;  
 220-240V: 740.8/742.0 W  
**Ready Mode:** 120V: 55.9 W; 220-240V: 57.9 (54.9) W  
**Sleep Mode:** 120V: 0.6 W; 220-240V: 4.0 or less (0.5) W  
**Power Off:** 120V: 0.1 W; 220-240V: 3.0 or less (0.1) W

**PRINTER SPECIFICATIONS**

**Standard Controller:** ARM Cortex-A53 Dual Core 1.4GHz  
 (for printing) & ARM Cortex-M3 100MHz (for energy saver)  
**PDLs / Emulations:** Common: PCL6 (PCL XL/PCL 5c), KPDL3  
 (PostScript3 compatible & AES Support), PDF with KPDL3  
 setting, XPS/Open XPS, Common Image Format: TIFF (KPDL3;  
 ON), JPEG (KPDL3; ON), URF, PWG Raster, PCLm, World: IBM  
 Proprinter, EPSON LQ-850, LinePrinter  
**Fonts:** Outline: 93 Fonts (PCL 6/KPDL3), 4 Fonts (Calibri/  
 Cambria); Bitmap: 1 Font, 79 Outline Fonts Graphics:  
 Supporting PRESCRIBE + JPEG image commands, One-  
 Dimensional Barcode: 45 Type; Two-Dimensional Barcode:  
 PDF417 1 Type  
**Windows OS Compatibility:** Windows 8.1, Windows 10  
 (32/64/arm64), Windows 11 (32/64/arm64), Windows Server  
 2012/R2, 2016, 2019  
**MAC OS Compatibility:** Requires Mac OS X v10.5 or Later  
**Linux OS Compatibility:** Linux Distro version: Debian 11,  
 Ubuntu 20.04, RHEL 8, CentOS Linux 8, Fedora 34, 35,  
 OpenSUSE 15.3  
**Interface:** 10BASE-T/100BASE-TX/1000BASE-T(TCP/IP,  
 NetBEUI), 1 High-Speed USB 2.0, 1 High-Speed USB 2.0 Host,  
 1 Expansion Slot; Optional: Wireless IB-37/38 LAN (Approx. 98  
 ft Range & Wi-Fi Direct), IB-51 (Approx. 328 ft Range); IB-50  
 Dual LAN NIC  
**Mobile Printing:** KYOCERA Mobile Print, KYOCERA My Panel,  
 KYOCERA Print Service Plug-in, Apple AirPrint®, Mopria®, and  
 Wi-Fi Direct<sup>1</sup>  
**Network Print and Supported Protocols:** Network printing:  
 TCP/IP, FTP, LPR, Port 9100, NetBEUI, Apple Bonjour; Internet  
 printing: IPP/1.0 (Some 1.1 functions are also supported);  
 E-mail printing: Data printing of E-mail received data, Data  
 format: PDF, PS, Text, TIFF, JPEG, XPS, OpenXPS; Secure  
 printing: IPP over TLS; Web PAGE Function; WSD Print: WSD  
 Compliance Scan/Print; PDF direct print: Use "KYOCERA NET  
 Direct Print", PDF Ver. 2.0, Encryption PDF, TIFF, JPEG, XPS  
 Mode; MPT Priority Function: 1) OFF, 2) ON, 3) Auto paper  
 feed; Pull printing: Option, Support with KYOCERA NET

Manager, Supports job selection and output by registered  
 user, Authentication from the panel or IC-Card authentication  
 kit (B); Connectivity: Plug & Play (USB), SNMP (Printer MIB  
 Support), HTTP (Command Center RX: web page), PnP-X (WS-  
 Discovery for WSD Print Service), Apple Bonjour  
**Drivers:** KX Driver, PCL Mini Driver, KPDL Mini Driver,  
 Windows Inbox Driver, Network FAX Driver, TWAIN Driver  
 (Network, USB, and BOX), WIA Driver (Network and USB),  
 MAC Driver, Linux Driver  
**Utilities:** KYOCERA Net Direct Print, Status Monitor, File  
 Management Utility, KYOCERA Print Center, KYOCERA Quick  
 Scan, Web Installer, KYOCERA Device Manager, KYOCERA  
 Net Viewer, Quick Network Setup, Maintenance Menu, Wi-Fi  
 Setup Tool, Firmware Upgrade Tool, Remote Panel, Command  
 Center RX; KYOCERA Fleet Services (KFS) Ready  
**Additional Print Features:** HyPAS capable<sup>3</sup>, EcoPrint, Private  
 Print, Proof and Hold, Quick Copy and Job Storage<sup>3</sup>, Print  
 Priority Setting, Job End Notification

**SECURITY SPECIFICATIONS**

Local and Network Authentication, Encryption Communication  
 (IPsec, HTTPS, LDAP over TLS, SNMPv3, SIEM/Syslog, SMTP  
 over TLS, POP over TLS), Optional TPM (Trusted Platform  
 Module) chipset when UG-50 is attached, SCEP, OCSP/CRL  
 (CRL: W/option Memory), ECDSA, Secure Boot, Run Time  
 Integrity Check, Support for FIPS 140-3 (option SSD), Common  
 Criteria (ISO/IEC-15408/EAL2 W/SSD), HDD Overwrite when  
 optional storage device is attached, IPP over TLS, HTTP over  
 SSL/TLS, FTP over SSL/TLS, Enhanced WSD over SSL/TLS,

**SCAN SPECIFICATIONS**

**Scan Type:** Color and Black & White Scanner  
**Scan Resolution:** 300dpi x 300dpi, 200dpi x 200dpi(Default),  
 200dpi x 100dpi, 600dpi x 600dpi, 400dpi x 400dpi, and  
 200dpi x 400dpi  
**Scanning Functions:** Banner Scan, Scan Resolution, Line Skip,  
 File Separation, Blank Page Skip Scan, WSD Scan (WIA Driver),  
 PC Send (SMB Version 3.0), E-mail Send (SMTP), FTP Send (FTP,  
 FTP over SSL), USB Send (USB), TWAIN Scan (KM-WSDL Scan  
 Operation Service - TWAIN Driver), WIA Scan (KM-WSDL  
 Scan Operation Service - WIA Driver), WSD Scan (WIA Driver),  
 ChromeOS(Scan) (eSCL), AirPrint (eSCL), Mopria (eSCL)  
**File Formats:** TIFF/PDF (MMR/JPEG), XPS, OpenXPS, PDF/A,  
 High Compression PDF; Optional: Searchable PDF and  
 OOXML / OOXML(OCR)<sup>3</sup>  
**Scan Speeds: Simplex BW/Color:** @200 dpi: 62ipm/47ipm;  
 @300 dpi: 62ipm/42ipm @600 dpi: 42ipm/22ipm  
**Duplex BW/Color:** @200 dpi: 122ipm/92ipm;  
 @300 dpi: 122ipm/82ipm; @600 dpi: 64ipm/34ipm  
**Original Size:** Min/Max: Glass/DP: Statement to Legal  
 (5.5" x 8.5" - 8.5" x 14"); Banner: DP Up to 36"

**COPY SPECIFICATIONS**

**Image Mode:** Map/Diagram: (256 tones & 2 bits/dot (FM),  
 Text: (256 tones & 2 bits/dot (FM), Photo: (256 tones & 2 bits/  
 dot (AM), Text + Photo: (256 tones & 2 bits/dot (FM)  
**Continuous Copy:** 1-999  
**Job Management:** Address Book: 200 (HyPAS), Job  
 Accounting: 100 (HyPAS), Panel Program: 20 (HyPAS),  
 Shortcut: 6 (HyPAS)  
**Magnification / Zoom:** 7 Reduction, 5 Enlargement Preset  
 Ratios, 25 - 400% in 1% Step Increments  
**Additional Features:** Auto Duplex (One-sided to Two-sided  
 and Two-sided to Two-sided), Continuous Scan, Blank Page  
 Skip Copy, Line Skip Copy, ID Card Copy

**DOCUMENT PROCESSOR**

**Type / Capacity:** Dual Scan Document Processor (DSDP) /  
 100 Sheets  
**Acceptable Originals:** Statement to Legal  
 (5.5" x 8.5" - 8.5" x 14")  
**Acceptable Weights:** Simplex / Duplex: 13 - 32lb Bond  
 (50 - 120gsm)

**FAX SPECIFICATIONS**

**Compatibility / Data Compression:** ITU-T G3 Fax / MMR,  
 MR, MH, JBIG  
**Transmission Speed / Modem Speed:** 33.6kbps  
**Fax Functions:** Fax Direct Tx, Fax Memory Tx, Scheduled  
 Transmission, Fax Polling Tx & Rx, Subaddress Tx, Subaddress  
 Confidential Rx, Subaddress bulletin board Rx, Forward Fax,  
 Network Fax Tx, Network Fax Rx, Shared Fax Driver, Speedy  
 transmission of Send Job (Scheduled Job)

**PAPER SUPPLY**

**Standard Paper Sources:** Single 500 Sheet Drawer,  
 100 Sheet Multipurpose Tray  
**Standard / Maximum Paper Sources:** 2 / 6 Including  
 Multipurpose Tray  
**Standard / Maximum Paper Capacity:** 600 Sheets /  
 2,600 Sheets  
**Paper Size:** Standard and MPT: Statement to Legal  
 (5.5" x 8.5" - 8.5" x 14"), Custom; MPT: Envelope, Banner  
**Paper Weight:** Standard / Optional Drawers: 16 lb. Bond - 32  
 lb. Bond (60 - 120gsm); MPT: 16 lb. Bond - 110 lb Index  
 (60 - 220gsm)  
**Standard Output Tray Capacity:** 500 Sheets (Face Down),  
 250 Sheets (Face Up)  
**Input Materials:** Standard / Optional Drawer: Plain Paper,  
 Bond Paper, Recycled Paper; MPT: Plain Paper, Bond Paper,  
 Labels, Recycled, Letterhead, Envelopes, OHP, Thin/Thick  
 Paper, Coated, Banner

**PAPER HANDLING OPTIONS**

**PF-3110:** Paper Feed Cassette (500 sheets x 4)  
**Paper Size:** Statement to Legal (5.5" x 8.5" - 8.5" x 14"),  
 Envelope, Custom  
**Dimensions / Weight:** 14.9" W x 16.1"D x 4.8" H / 8.4 lbs.

**ADDITIONAL OPTIONS**

**MS-5100 B:** Manual Stapler  
**Paper Tray:** PT-320 (Face Up 250 Sheets)  
**Print Management:** ThinPrint (UG-33)  
**Security:** Card Authentication Kit(B)  
**SD/SDHC Card:** 16 and 32 GB  
**SSD:** HD-17: 64 GB SSD / HD-18: 256 GB SSD /  
 HD-19: 512 GB SSD  
**Wireless LAN:** IB-37, IB-38, and IB-51  
 (does not support HyPAS or KFS).  
**Additional NIC:** IB-50 Gigabit NIC  
**Optional Memory:** 2 GB DIMM Memory (DDR3)  
**Other:** Scan Extension Kit (A), USB Keyboard  
 (Customer Supplied)

**NOTE:**

<sup>1</sup>Requires Optional IB-37 or IB-38

<sup>2</sup>Requires Optional Scan Extension Kit (A)

<sup>3</sup>Requires SD Card, HD-17, HD-18, or HD-19

Kyocera Document Solutions has championed innovative technology since 1934. We enable our customers to turn information into knowledge, excel at learning and surpass others. With professional expertise and a culture of empathetic partnership, we help organizations put knowledge to work to drive change.

Specifications and design are subject to change without notice.  
For the latest on connectivity visit [kyoceradocumentsolutions.us](https://kyoceradocumentsolutions.us).  
ECOSYS, PRESCRIBE, Kyocera Net Manager, Kyocera Net Viewer, Kyocera Device Manager, PDF Direct Print, Command Center RX, and KX Driver are trademarks of The Kyocera Companies. Mac OS and AirPrint are trademarks of Apple, Inc. Mopria is a trademark of Mopria Alliance, Inc. Windows is a trademark of Microsoft, Inc. All other trademarks are the property of their respective owners.



Kyocera Document Solutions Partner

KYOCERA Document Solutions America  
225 Sand Road, PO Box 40008  
Fairfield, New Jersey 07004-0008, USA  
Tel: 973-808-8444



[kyoceradocumentsolutions.us](https://kyoceradocumentsolutions.us)

Kyocera Document Solutions does not warrant that any specifications mentioned will be error-free. Specifications are subject to change without notice. Information is correct at time of going to press.  
All other brand and product names may be registered trademarks or trademarks of their respective holders and are hereby acknowledged.  
©2023 KYOCERA Document Solutions America, Inc.